

Ersatzteil für Montagevorrichtung S3190
Sechskant **ERMANN BALZI**

Replacement Part for Assembly Device S3190
Hexagon Insert

S3191/...

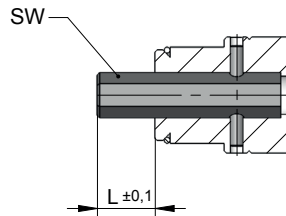

S3190/ 0	S3190/ 1	S3190/ 2	S3190/ 3	L	SW	Best. Nr. / Order No.
X				5	2	S3191/ 2
	X			5	2,5	S3191/ 2,5
		X		5	3	S3191/ 3
			X	6,5	5	S3191/ 5