

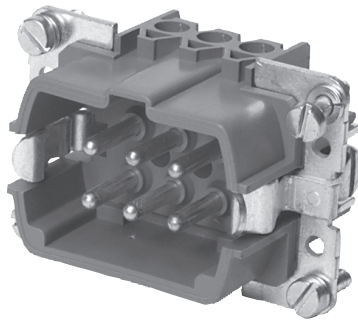

**Mehrpole Steckverbinder,
Steckereinsatz**

**Multi-pole Connector,
Male Insert**

S5310/ . . .

- Kunststoff-Isolierkörper.
 - Schraubanschluss, 2,5 mm².
 - 6, 10, 16, oder 24-polig.
 - 400 V / 16 A.
- Insert: Polyamide.
 - Threaded terminal end, 2.5 mm².
 - 6, 10, 16, or 24-pole.
 - 400 V / 16 A.



für / for S5306/ . . .	IP	T _{max.} [°C]			n Pole / Poles	Best. Nr. / Order No.
S5306/ 6	65	125	X	X	6	S5310/ 6
S5306/ 10	65	125	X	X	10	S5310/ 10
S5306/ 16	65	125	X	X	16	S5310/ 16
S5306/ 24	65	125	X	X	24	S5310/ 24