

Kontaktstift

Contact Rod

S7103/ ...

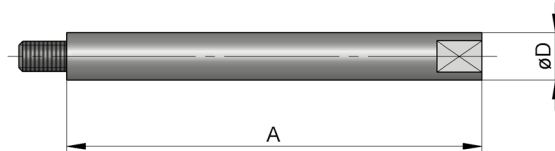

A	D	s Plattenstärke / Plate thickness	Best. Nr. / Order No.
8,4	6,3	56	S7103/ 56
18,3	6,3	66	S7103/ 66
28,6	6,3	76	S7103/ 76
46,6	6,3	96	S7103/ 96
68,6	6,3	116	S7103/ 116
148,3	6,3	196	S7103/ 196

Einbauhinweise:

Mounting instructions:

19,2^{-0,05}

